

Automatic

Door Motor

Kabuk Group

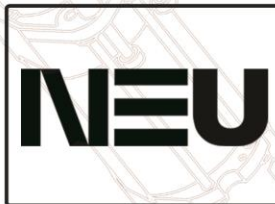

|Persepolice Iran

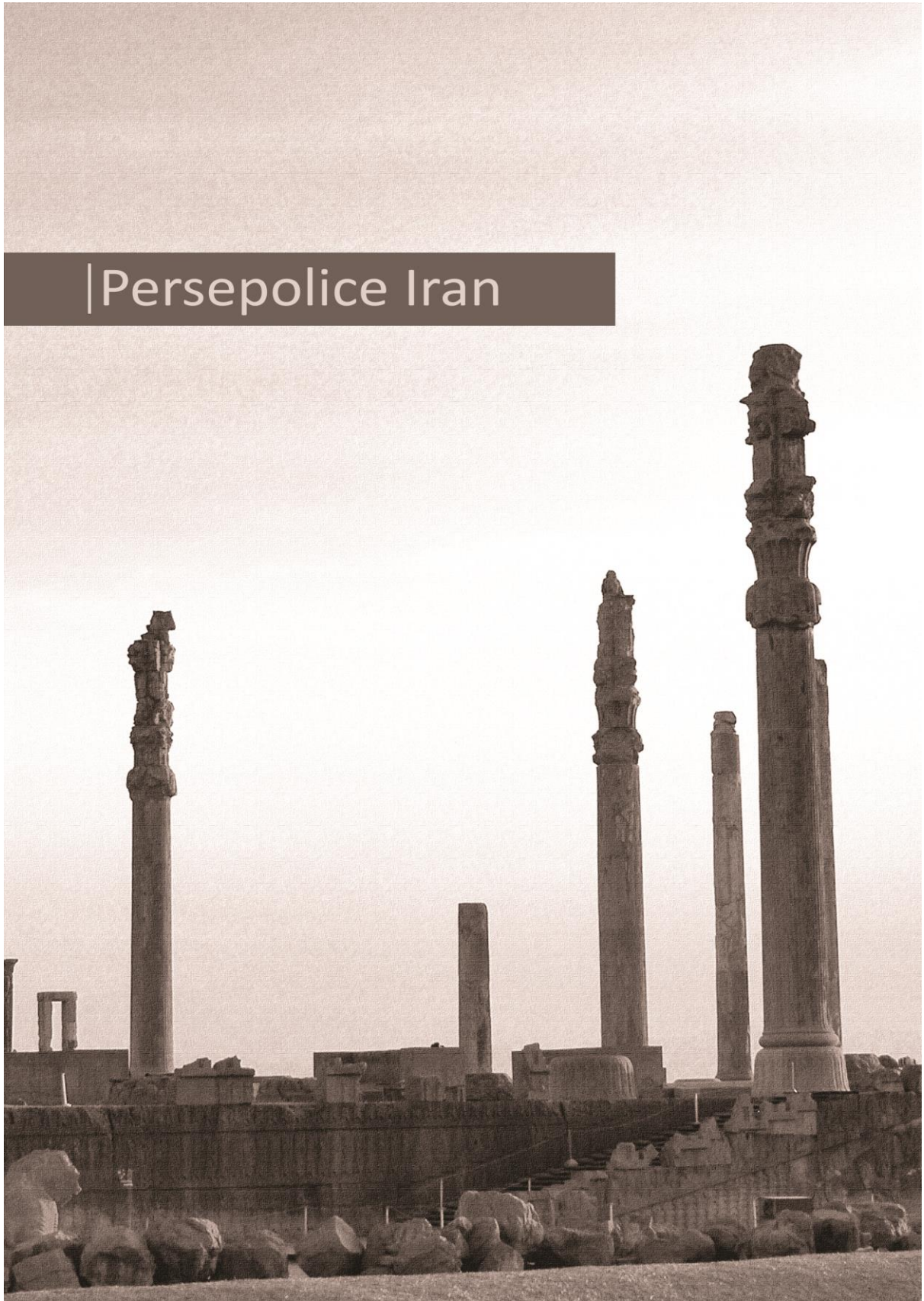

History

Kabuk Sazan Jonoob is the corporate parent company to Hutte and Casa brand. This company established in 2005 and after 12 years of continues progress and improvement, it becomes one of the biggest supplier of automatic door motor in Iran.

One of our biggest proud and main reason of success is that Hutte trading company tried to Employed experienced and committed people alongside cooperating with great representatives of all over the country.

Providing the highest quality product along with the best after sales service is a need that with God's whiling and the efforts of each individual of this company, is on the path to fulfillment. The head office is located in Shiraz and consists of experienced and professional team in R & D department, which carefully controls the quality of each motor's component and manufacturing process to deliver high quality product to our esteemed customers.

Tubular motor

Hulle

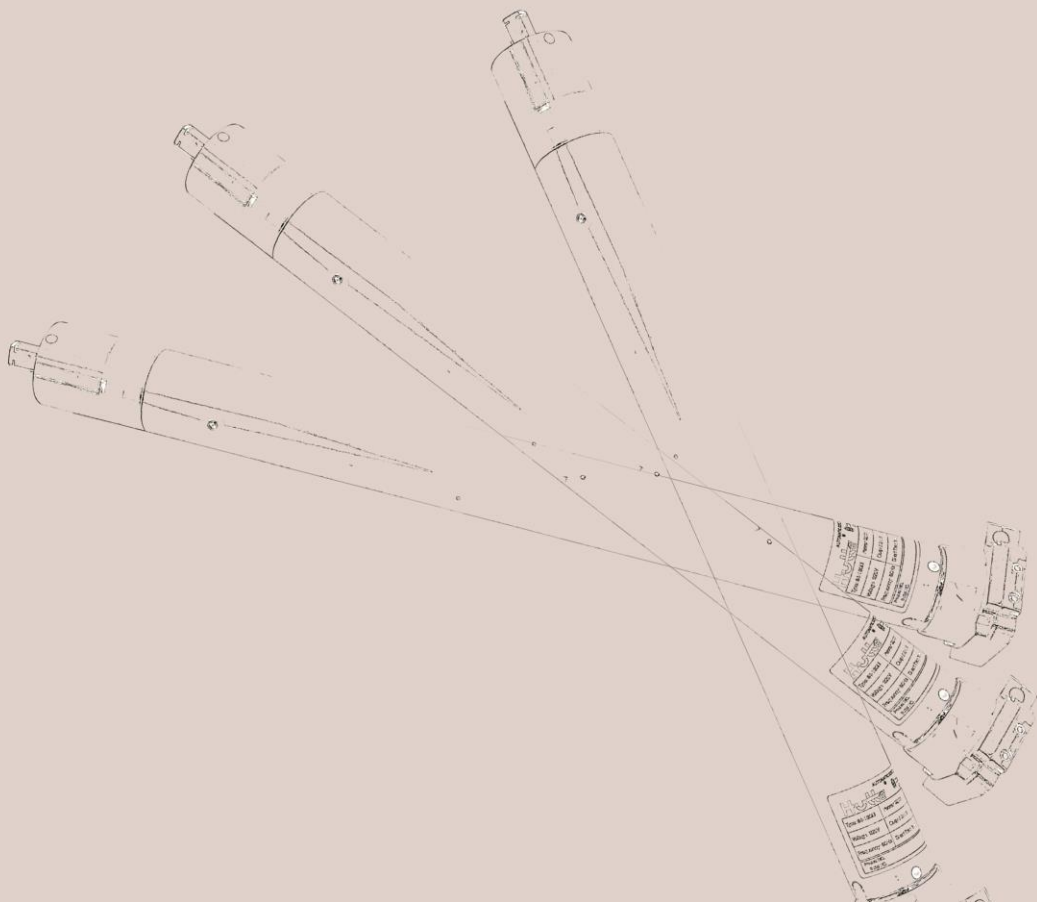

Tubular motor:HA45



Tubular motor



Product Features:

- Exquisite red appearance easy installation.
- Smooth running, DB level as low as 45DB.
- Standard mechanical limit switch with silent on the limit head, with accurate limit position.
- Particular for motorized projects whit weight below 50Kg,blinds, screens and shutters etc.

Motor Size:

ابعاد موتور:

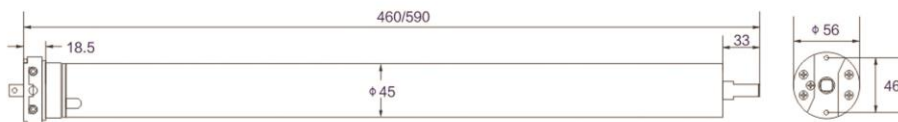

Specifications:

مشخصات:

Model	Torque (N.m)	Rotation (rpm)	Voltage (V)	Frequency (Hz)	Power (W)	Current (A)	Limit Round	IP (IP)	Working Time (min)	Net Weight (Kg)	Tube Diameter (mm)
HA45-10	10	15	230	50	162	0.71	26	IP44	≥4	2.1	57/67
HA64-20	20	15	230	50	178	0.78	26	IP44	≥4	2.3	57/67
HA45-30	30	15	230	50	235	1.03	26	IP44	≥4	2.8	57/67
HA45-40	40	12	230	50	276	1.20	26	IP44	≥4	3.0	57/67
HA45-50	50	12	230	50	282	1.23	26	IP44	≥4	3.2	57/67
HA45-50 خاص کن دار	50	12	230	50	282	1.23	26	IP44	>4	3.2	57/67

Tubular motor

Hulle

Tubular motor:HA59



Product Features:

- New designed limit head, adapted for more modes of installation.
- Parts built in motor design and space saving.
- Mechanical limit switch, with accurate limit position.
- Easy installation and smooth running, DB level below 42dB.
- Compatible with HA control system, wireless controlled, More secure and stable.
- Maximum lift capacity reaches 200KG
- Manual override make it possible to operate normally in case of power failure

Motor Size:

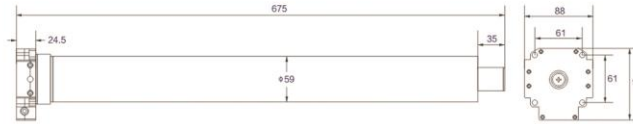

ابعاد موتور:

Specifications:

مشخصات:

Model	Torque (N.m)	Rotation (rpm)	Voltage (V)	Frequency (Hz)	Power (W)	Current (A)	Limit Round	IP (IP)	Working Time (min)	Net Weight (Kg)	Tube Diameter (mm)
HA59-80	80	12	230	50	350	1.50	36	IP44	≥4	5.8	67/82
HA59-100	100	12	230	50	441	1.92	36	IP44	≥4	6.2	67/82
HA59-120	120	12	230	50	450	2.00	36	IP44	≥4	6.5	67/82
HA59-140	140	9	230	50	465	2.12	36	IP44	≥4	6.8	67/82
HA59-190	190	9	230	50	530	2.7	36	IP44	>4	7.1	67/82
HA59-DC100	100	8	24	50	72	6.5	36	IP44	>4	5.5	67/82

High Speed Motor:HA59



Tubular motor



Product Features:

- Compatible with HA control system, wireless controlled, More secure and stable.
- Manual override make it possible to operate normally in case of power failure
- New designed limit head, adapted for more modes of installation.
- New Generation of 59mm Tubular motor With 26 RPM Speed
- Easy installation and smooth running,DB level below 42dB.
- Mechanical limit switch, with accurate limit position.
- Parts built in motor design and space saving.
- Maximum lift capacity reaches 200KG

Motor Size:

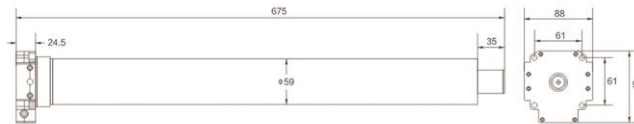

ابعاد موتور:

Specifications:

مشخصات:

Model	Torque (N.m)	Rotation (rpm)	Voltage (V)	Frequency (Hz)	Power (W)	Current (A)	Limit Round	IP (IP)	Working Time (min)	Net Weight (Kg)	Tube Diameter (mm)
HA59-80 (26rpm)	80	26	230	50	425	1.5	36	IP44	≥4	5.8	67/82

**Product Features:**

- HA64 Series motor is suit for the miniature car door,electric rolling shutter,electric sunshade.
- The lift capacity diverse according to the different torque.
- The max. lift capacity reaches 221 Kg in conjunction with different out tube.
- Manual override devices ensure the normal operating in case of emergency and power failure.

Motor Size:

ابعاد موتور:

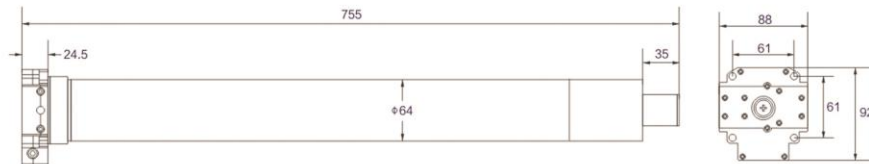

Specifications:

مشخصات:

Model	Torque (N.m)	Rotation (rpm)	Voltage (V)	Frequency (Hz)	Power (W)	Current (A)	Limit Round	IP (IP)	Working Time (min)	Net Weight (Kg)	Tube Diameter (mm)
HA64-160M	160	9	230	50	492	2.2	36	IP44	≥4	7.8	106

Tubular Motor:HA92

Hulte

Tubular motor



Product Features:

- HA92-M2 Series tubular motor is suitable for the large garage,shop rolling shutter, factory doors,
- The max.lift capacity reached 400kg in conjunction with different size of tubes.
- Side-magnetic conica surface brake system are adopted to make sure the motor security.
- Manual override device ensure the normal operating in case of emergency and power failure.

Motor Size:

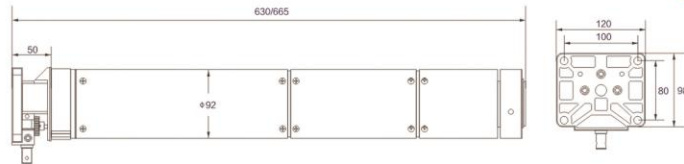

ابعاد موتور:

Specifications:

مشخصات:

Model	Torque (N.m)	Rotation (rpm)	Voltage (V)	Frequency (Hz)	Power (W)	Current (A)	Limit Round	IP (IP)	Working Time (min)	Net Weight (Kg)	Tube Diameter (mm)
HA92-230M	230	12	230	50	830	3.6	16	IP44	≥4	12	106
HA92-300	300	8	230	50	880	3.8	16	IP44	≥4	14.6	106
HA92-330	330	8	230	50	910	4.0	16	IP44	≥4	15	106

Tubular motor



Tubular Motor:CA59

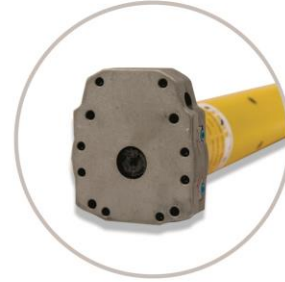

Product Features:

- Easy Setting Of Final Positions.
- New Design Of Limit Head
- Quiet, Smooths Operation.
- Overheat Protection For Motor.

Motor Size:

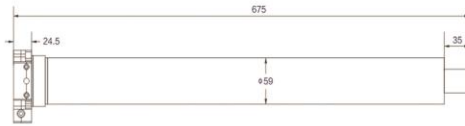

ابعاد موتور:

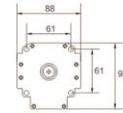

Specifications:

مشخصات:

Model	Torque (N.m)	Rotation (rpm)	Voltage (V)	Frequency (Hz)	Power (W)	Current (A)	Limit Round	IP (IP)	Working Time (min)	Net Weight (Kg)	Tube Diameter (mm)
CA59-120M	120	12	230	50	450	1.58	IP44	≥4	7.8	67/82	
CA59-140M	140	9	230	60	465	1.62	IP44	≥4	7.8	67/82	

Rebound System

Tubular motor



High Speed Motor: HA59

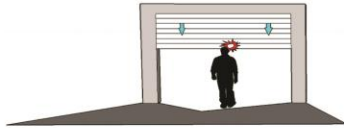

موتورهای توبولار معمولی

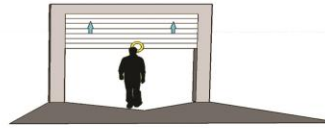

موتور توبولار هیوت همراه با سیستم ریباند

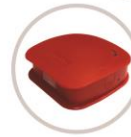

Product Features:

- New designed limit head, adapted for more modes of installation.
- Parts built in motor design and space saving.
- Mechanical limit switch, with accurate limit position.
- Easy installation and smooth running, DB level below 42dB.
- Preventing from probable danger by using Hutte new rebound dydtem.
- Compatible with HA control system, wireless controlled, More secure and stable.

Specifications :

ابعاد موتور:

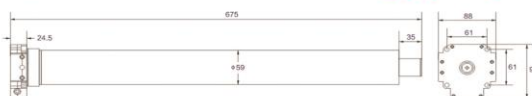

Specifications :

مشخصات:

Model	Torque (N.m)	Rotation (rpm)	Voltage (V)	Frequency (Hz)	Power (W)	Current (A)	Limit Round	IP (IP)	Working Time (min)	Net Weight (Kg)	Tube Diameter (mm)
HA59-80	80	12	230	50	350	1.50	36	IP44	≥4	5.8	67/82
HA59-100	100	12	230	50	441	1.92	36	IP44	≥4	6.2	67/82
HA59-120	120	12	230	50	450	2.00	36	IP44	≥4	6.5	67/82
HA59-140	140	9	230	50	465	2.12	36	IP44	≥4	6.8	67/82



Side Motor

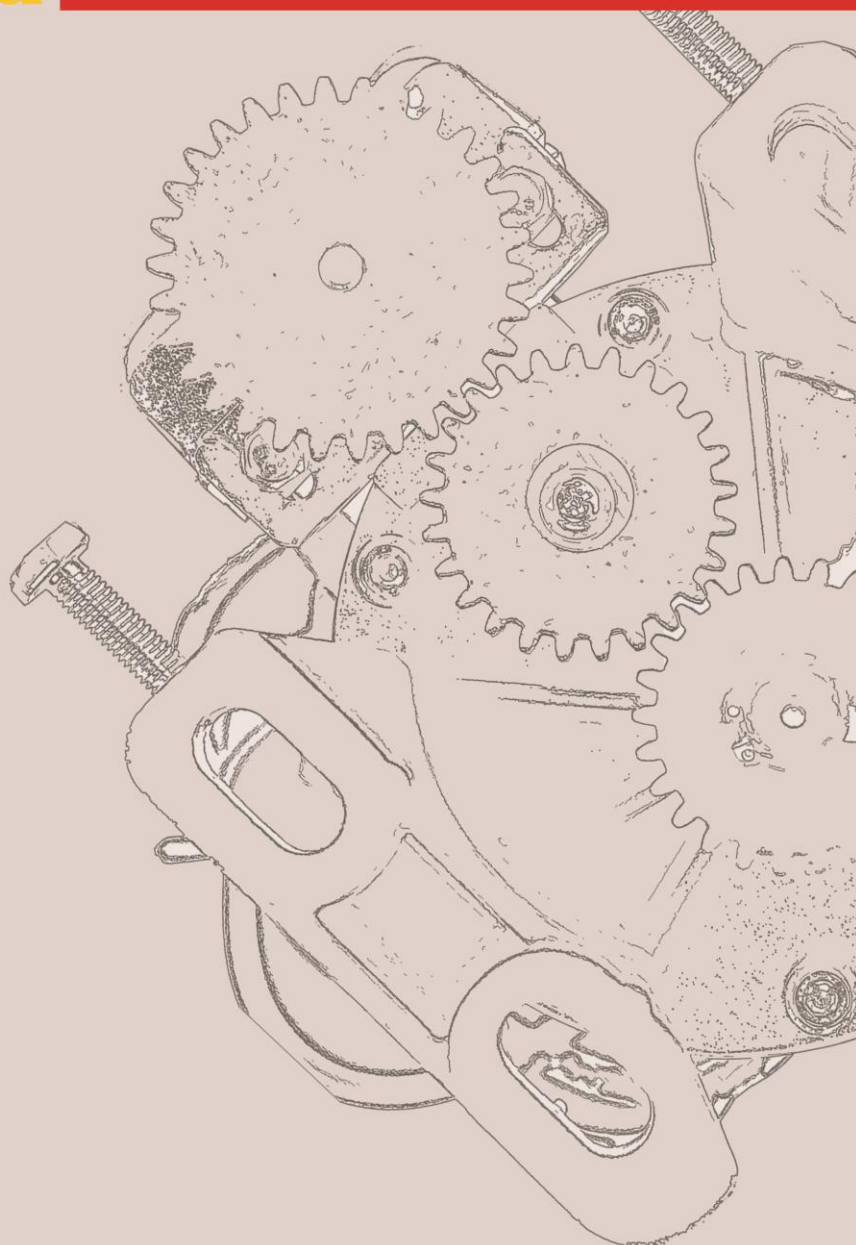

Product Features:

- Attractive appearance, compact conformation, strong lift power.
- low vibration and noise, low power dissipation.
- Small and light weight, easy installment, have long performance life, dependable performance
- Have the port for remote control, could match remote system.
- When the power cut, could use manual operate or match control box using.



Specifications:

مشخصات:

220V/50,380V/50Hz							
Specifications							
Model	Power (W)	Advancing Force (Kg.f)	Torque (N.m)	Speed (r/min)	Max lifting Height (m)	Chain No	Tube diameter (mm)
AC200-1p	170	200	110	5.3	6	08B	104
AC300-1p	500	300	168	6.5	6	10A	104
AC500-1p	565	500	343	6.5	6	10A	104

Side Motor AC: 800-1000



Side Motor

Product Features:

- Attractive appearance, compact conformation, strong lift power.
- low vibration and noise, low power dissipation.
- Small and light weight, easy installment, have long performance life, dependable performance
- Have the port for remote control, could match remote system.
- When the power cut, could use manual operate or match control box using.



Specifications:

مشخصات:

220V/50,380V/50Hz							
Specifications							
Model	Power (W)	Advancing Force (Kg.f)	Torque (N.m)	Speed (r/min)	Max lifting Height (m)	Chain No	Tube diameter (mm)
AC800-1p	700	800	647	5.06	9	10A	129
AC1000-1p	750	1000	715	5.5	9	12A	129

Product Features:

- Attractive appearance, compact conformation, str
- low vibration and noise, low power dissipation.
- Small and light weight, easy installment, have low performance
- Have the port for remote control, could match remote
- When the power cut, could use manual operate or



Specifications:

مشخصات:

ولتاژ ورودی 220V/50,380V/50Hz

مشخصات فنی

Model	Power (W)	Advancing Force (Kg.f)	Torque (N.m)	Speed (r/min)	Max lifting Height بالابرنده	Chain No زنجیر	Tube diameter (mm)
AC1300-1p	600	1300	1401	6.4	9	12A	209
AC1500-1p	800	1500	1617	4.9	9	16A	209
AC2200-1p	850	2200	2450	3.6	12	16A	209

Side Motor DC: 200-750



Side Motor

Product Features:

- Attractive appearance, compact conformation, strong lift power.
- low vibration and noise, low power dissipation.
- Have the port for remote control, could match remote system.
- Ability to work even in power failure due to using batteries in UPS



Specifications :

مشخصات:

Model	Power (W)	Advancing Force (Kg.f)	Torque (N.m)	Speed (r/min)	Max lifting Height بالابرنده	Chain No زنجير	Tube diameter (mm)
DC24V-200KG	160	200	110	10.5	4.5	10A	104
DC24V-300KG	210	300	168	5.4	6	10A	104
DC24V-500KG	220	500	343	5.7	6	10A	104
DC24V-750KG	240	750	606	5.2	9	10A	129

Product Features:

- Attractive appearance, compact conformation, strong lift power.
- low vibration and noise, low power dissipation.
- Small and light weight, easy installment, have long performance life, dependable performance
- Have the port for remote control, could match remote system.
- When the power cut, could use manual operate or match control box using.



Specifications :

مشخصات :

220V/50Hz ,							
Specifications :							
Model	Power (W)	Advancing Force (Kg.f)	Torque (N.m)	Speed (r/min)	Max lifting Height	Chain No	Tube diameter (mm)
AC300-1p	480	300	168	6.5	6	10A	104
AC500-1p	620	500	343	6.5	6	10A	104

Side Motor DC:300-500



Side Motor

Product Features:

- Attractive appearance, compact conformation, strong lift power.
- low vibration and noise, low power dissipation.
- Have the port for remote control, could match remote system.
- Ability to work even in power failure due to using batteries in UPS



Specifications:

مشخصات:

Model	Power (W)	Advancing Force (Kg.f)	Torque (N.m)	Speed (r/min)	Max lifting Height	Chain No	Tube diameter (mm)
DC24V-300KG	210	300	168	6.6	6	10A	104
DC24V-500KG	220	500	343	6.6	6	10A	104

Side Motor

DC: 300-500

NEU

Side Motor

Product Features:

- Light weight and portable with best quality.
- Very low vibration and noise, long lasting life.
- Ability to operate, in times of power outages, DVe to battery usage.
- Easy to operate with high safety.
- One year warranty.



Specifications:

مشخصات:

220V/50,380V/50Hz

Specifications:

Model	Power (W)	Torque (N.m)	Speed (r/min)	Maximum height (m)
Neu-Dc300	150	168	3.7	6
Neu-Dc500	240	345	4.6	6

RoHS  CE CIQ

Product Features:

- Optimum design, light weight with bes quality.
- Very low vibration and noise, long lasting life.
- Manually open and close doors in case of emergency and power outage.
- Easy to operate with high safety.
- One year warranty.



Specifications :

مشخصات:

220V/50,380V/50Hz

Specifications :

Model	Power (W)	propulsion force (Kg.f)	Torque (N.m)	Speed (r/min)	Maximum high (m)	Shaft diameter (inch)
Neu-Ac300	250	300	168	5.2	6.0	4
Neu-Ac500	370	500	345	6.2	7.0	4

Side Motor

DC: 300-500



Side Motor

Product Features:

- Side motor with aluminium wire.
- Full option but cheap in price in the market.
- Full option receiver.
- Capability to install photocel.
- Capability to install flasher.
- Autoclose function.
- 4 channel



Specifications:

مشخصات:

Model	Voltage (V)	Frequency (Hz)	Working time (min)	Operation temperature (°c)	Lifting capacity (kg)	Output torque (N.m)	Maximum height (m)	Power (W)	Ip index
AC300-1p	220	50	5	20-50	300	168	6	396	IPX4
AC500-1p	220	50	5	20-50	500	345	6	462	IPX4

RoHS  CE CIQ

Product Features:

- Side motor with aluminium wire.
- Full option but cheap in price in the market.
- Full option receiver.
- Capability to install photocel.
- Capability to install flasher.
- Autoclose function.
- 4 channel

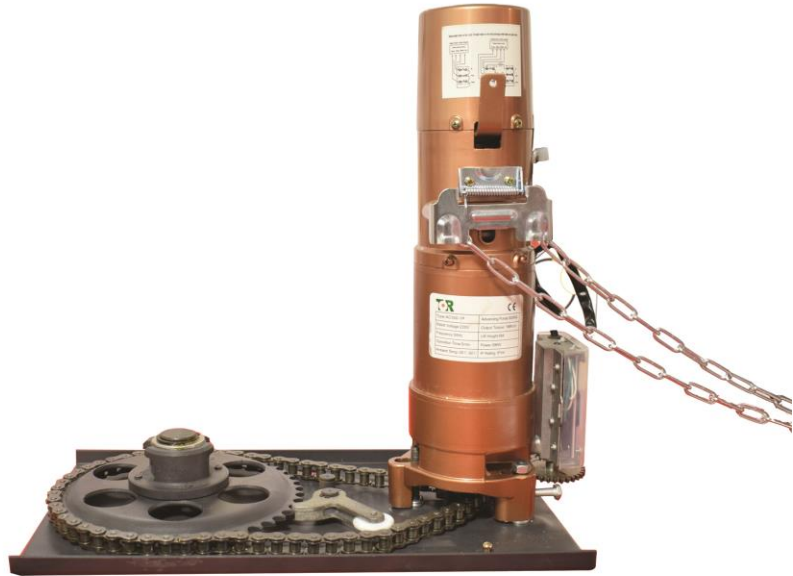

Specifications:

مشخصات:

Model	Voltage (V)	Frequency (Hz)	Working time (min)	Operation temperature (°C)	Lifting capacity (kg)	Output torque (N.m)	Maximum height (m)	Power (W)	Ip index
AC300-1p	220	50	5	20-50	300	168	6	396	IPX4
AC500-1p	220	50	5	20-50	500	345	6	462	IPX4

Base Plate



Base Plate
Side Motor



Includes:

- bracket board, side pannel, a big sprocket wheel,
- a small sprocket wheel, three discs, a chain, a shaft

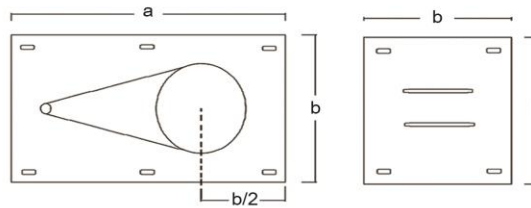

Specifications:

مشخصات:

Model	Main plate (a*b)	Side plate (b*b)	Thickness (mm)	Type
CASA AC 300-500	515*280 mm	270*270 mm	3.5 mm	چرخ 3
CASA DC 300	515*280 mm	270*270 mm	3.5 mm	چرخ 3
CASA DC 500	545*320 mm	320*320 mm	3.5 mm	چرخ 4
HUTTE AC 300-500	540*320 mm	320*320 mm	3.5 mm	چرخ 3
HUTTE DC 300	540*320 mm	320*320 mm	3.5 mm	چرخ 3
HUTTE DC 500	545*320 mm	320*320 mm	3.5 mm	چرخ 4
high speed AC 300-500 DC 300	545*320 mm	320*320 mm	3.5 mm	چرخ 3

Hulte

Central motor

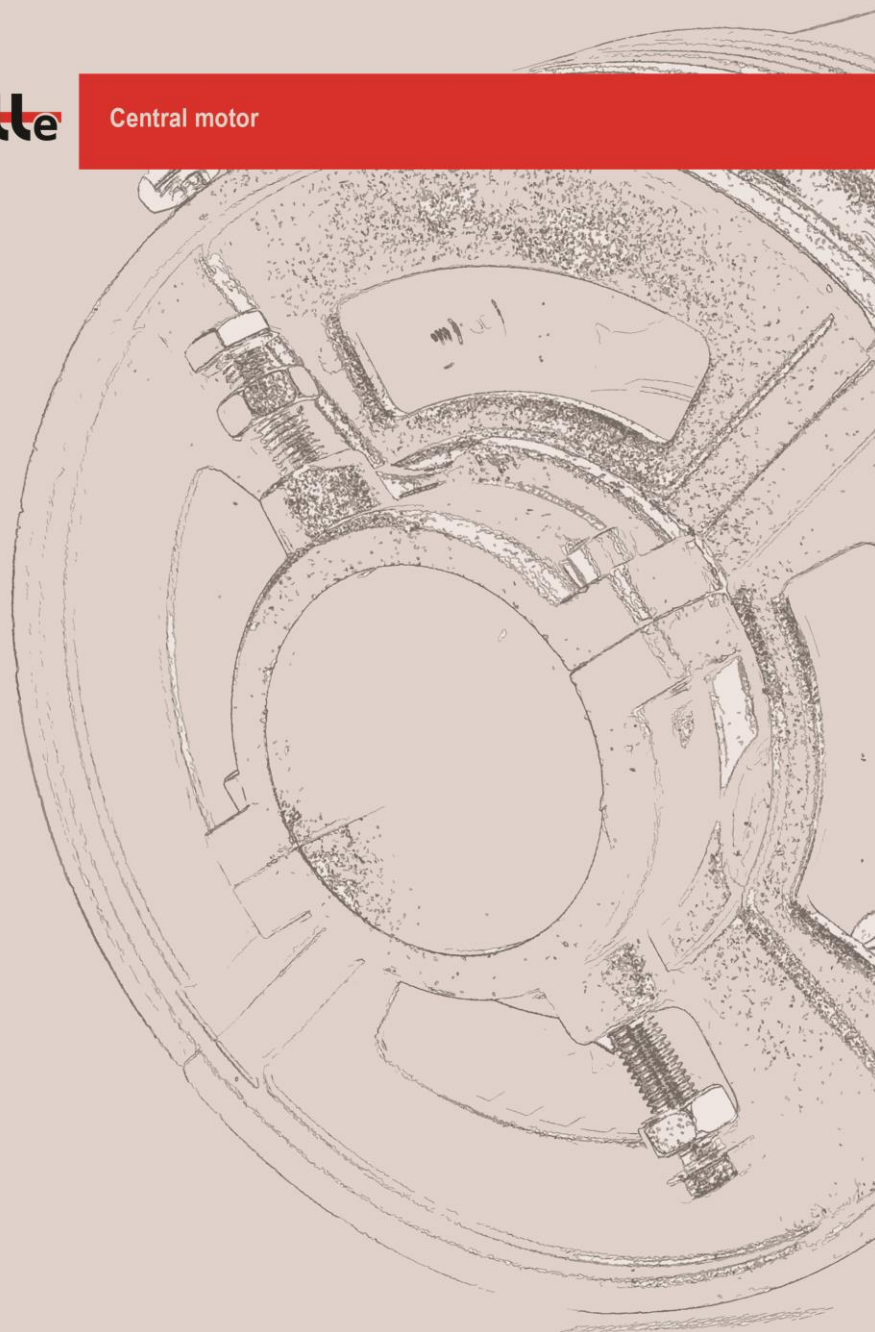

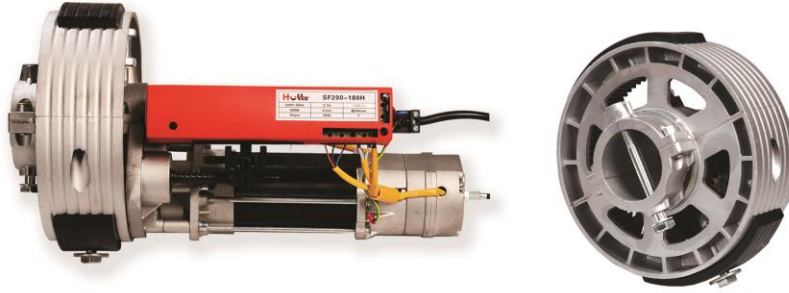
**Product Features:**

- Attractive appearance, compact conformation, strong lift power.
- low vibration and noise, low power dissipation.
- Small and light weight, easy installment, have long performance life, dependable performance
- Have the port for remote control, could match remote system.
- When the power cut, could use manual operate or match control box using.

Specifications:

مشخصات:

Model	Torque (N.m)	Rotation (rpm)	Working Time (min)	Voltage (V)	Frequency (Hz)	Power (W)	Current (A)	Net Weight (Kg)	Tube Diameter (mm)	Weight (Kg)
SF200/60-180H	180	10	≥4	230	50	750	3.3	200	60	10.5

Central Motor

SF240/76



Central motor

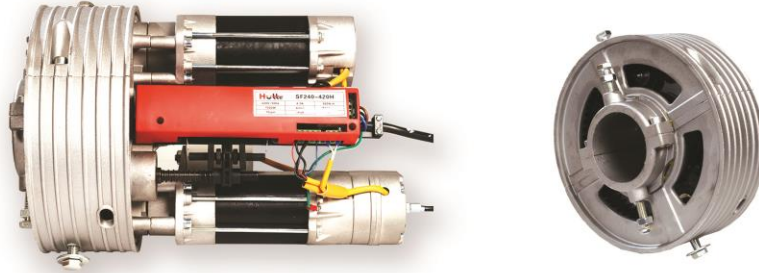

Product Features:

- Attractive appearance, compact conformation, strong lift power.
- low vibration and noise, low power dissipation.
- Small and light weight, easy installment, have long performance life, dependable performance
- Have the port for remote control, could match remote system.
- When the power cut, could use manual operate or match control box using.

Specifications:

مشخصات:

Model	Torque (N.m)	Rotation (rpm)	Working Time (min)	Power (W)	Current (A)	Net Weight (Kg)	Tube Diameter (mm)	Weight (Kg)
SF240/76-420H	420	10	≥4	1000	4.36	360	76	15

System Controller

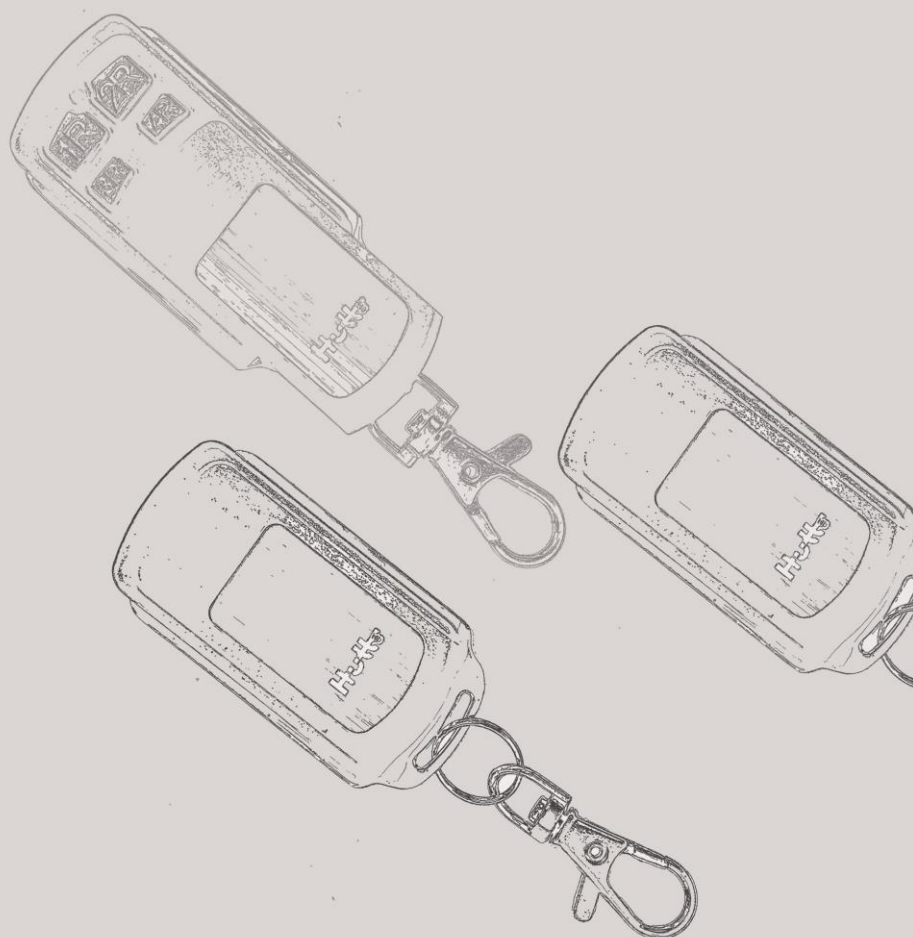

Control system



System Controller

Product Features

- Auto close and ability to installing photocell and flasher in full channel receiver
- Small size , Easy installation , External connection with switch
- Ability to installing to 60 remotes
- Capability to customization of operating



Model: c0111 Full Option
Usage type: Tubular Motor
Frequency: 433.92MHZ
Codding type: Fixed Code
Power: ≤800W
Voltage: 230Vac50hz/115Vac60Hz
Dimension: 100*9.5*30mm

Model: c0110 4Channel
Usage type: Tubular Motor
Frequency: 433.92MHZ
Codding type: Fixed Code
Power: <800W
Voltage: 230Vac50hz/115Vac60Hz
Dimension: 100*9.5*30mm



Model: C0113 Hopping
Usage type: Tubular Motor
Frequency: 433.92MHZ
Codding type: Hopping code
Power: ≤800W
Voltage: 230Vac50hz/115Vac60Hz
Dimension: 100*9.5*30mm



Model: c0112 Anti-crash
Usage type: Tubular Motor
Frequency: 433.92MHZ
Codding type: Fixed code
Power: ≤800W
Voltage: 230Vac50hz/115Vac60Hz
Dimension: 100*9.5*30mm

Product Features:

- Usable for any kind of Tubular and Side Motors
- Ability to installing photocell and flasher
- Auto Close system



Model: C0101
 Type of Use: AC Side Motor
 Frequency: 433.92MHZ
 Codding type: Hopping code
 Power: ≤800W
 Voltage: 230Vac50hz/115Vac60Hz
 Dimension: 100*9.5*30mm

Model: C0107
 Type of Use: AC Side Motor
 Frequency: 433.92MHZ
 Codding type: Hopping code
 Power: ≤800W
 Voltage: 230Vac50hz/115Vac60Hz
 Dimension: 100*9.5*30mm



Model: C0115 3 Relay reciever
 Type of Use: Any kind of Automatic Door Motors
 Frequency: 433.92MHZ
 Codding type: Fixed code
 Power: ≤800W
 Voltage: 230Vac50hz/115Vac60Hz
 Dimension: 100*9.5*30mm

DC,AC



System Controller

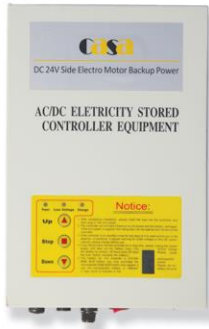

C0203



C0201

Model: **Co203-C0201**
Usage type: **DC Side Motor**
Frequency: **433.92MHZ**
Coddng type: **Hopping code**
International Protection: **IP30**

Product Features:

- Usable for any kind of Tubular and Side Motors
- Ability to installing photocell and flasher
- Auto Close system



Model: **C0207**
Usage type: **DC Side Motor**
Frequency: **433.92MHZ**
Coddng type: **Hopping code**
International Protection: **IP30**



C0114



C0102

Model: **C0114-C0102**
Usage type: **AC Tubular Motor, AC Side Motor**
Frequency: **433.92MHZ**
Coddng type: **Fixed code**
International Protection: **IP30**



R0101



R0204

R0301

R0203



R0302

R0501

R0401

Model	Frequency (HZ)	Coding type	Channel	International Protection
R0101	433.92	Hopping	3	IP30
R0204	433.92	Learning	4	IP30
R0301	350	Hopping	4	IP30
R0203	433.92	Learning	4	IP30

Model	Frequency (HZ)	Coding type	Channel	International Protection
R0302	433.92	Hopping	4	IP30
R0501	433.92	Dipswitch	4	IP30
R0401	350	Learning	4	IP30

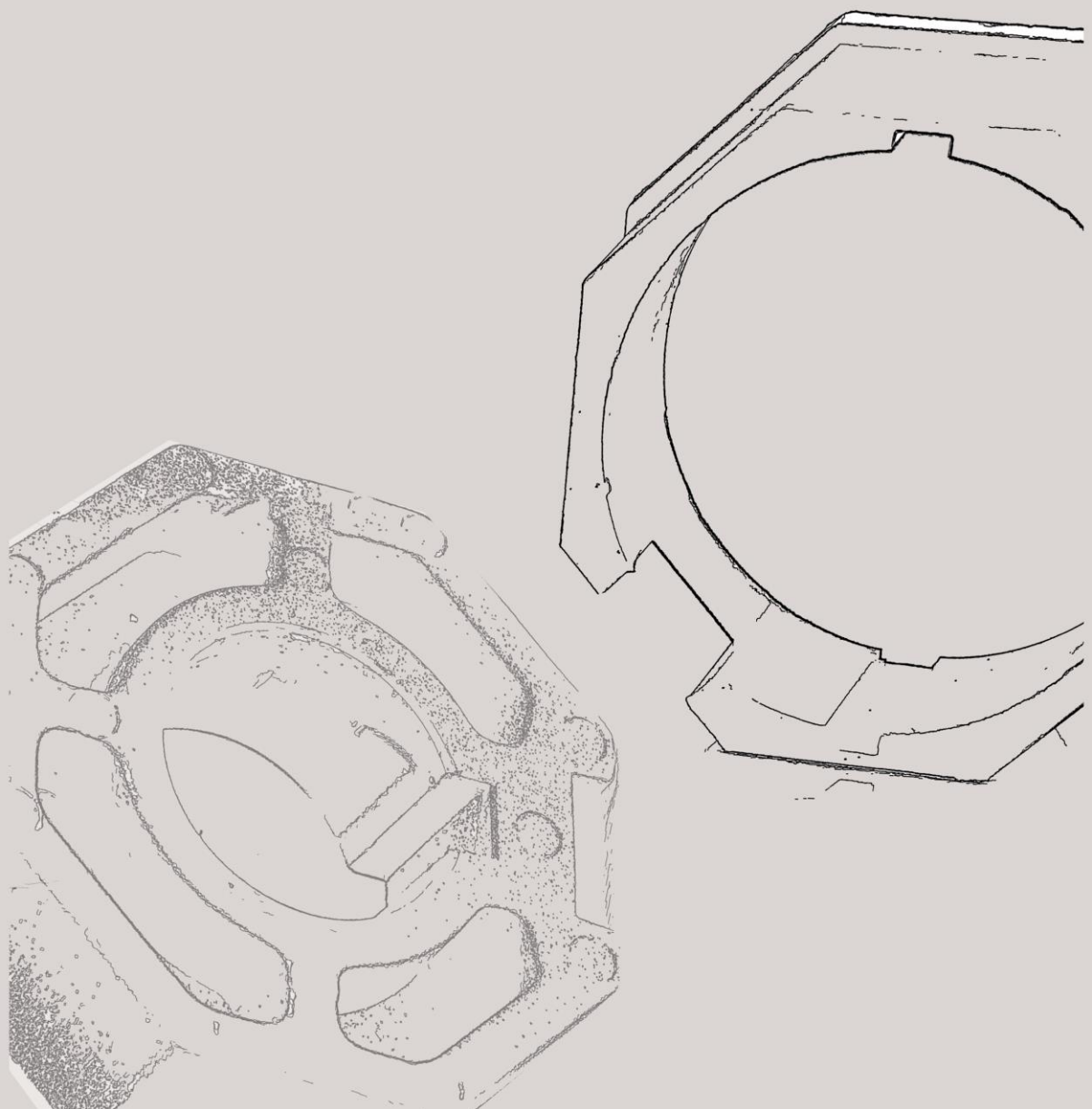



Product Features:

- Smart photocell with detection ability
- Ability for installation up to 7 meters
- Lifetime and long lasting strength
- Guarantee of door safety



Product Features:

- Lifetime and long lasting strength
- Guarantee of door safety



Product Features:

- Including 3 types: 12V DC , 24v DC, 220-265V Ac
- Including antend in order to increase transmitter distance range.



End-cap Tubular
Motor



Part

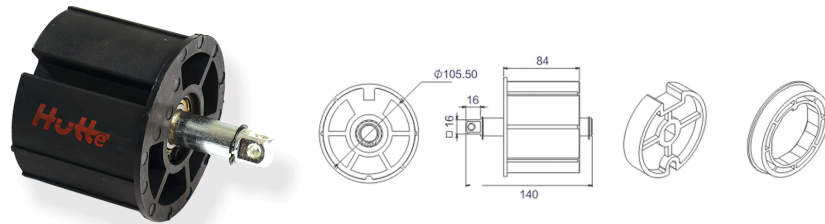

HA-φ106

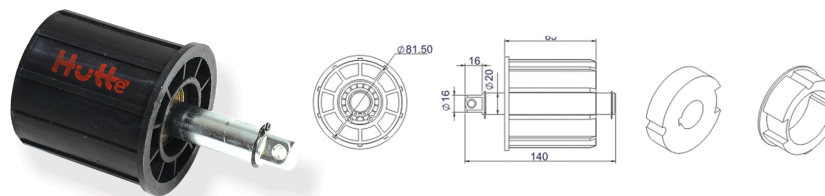

HA-φ82

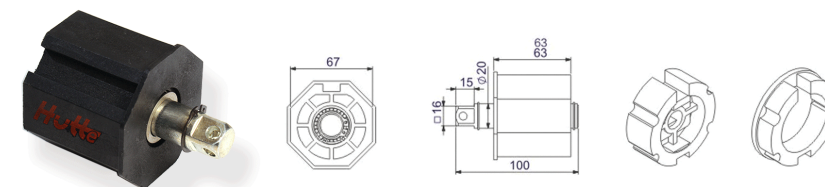

HA-H67

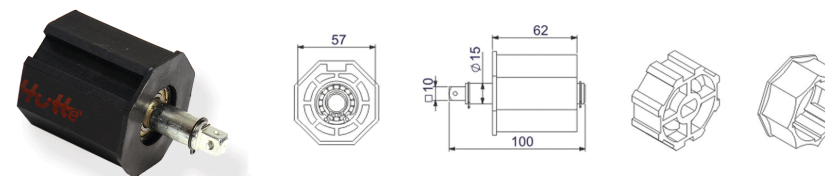

HA-H57

■ Square Bracket

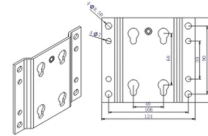

B0207

■ Square Bracket

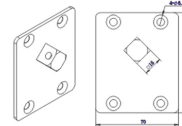

B0204

■ Star Bracket

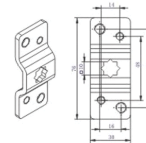

B0202

■ Regular Bracket

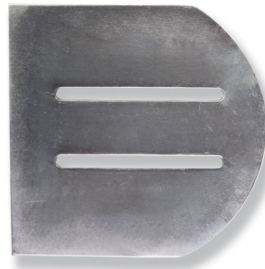

B0201

■ Releasing Handle



A0101



Sliding Operator



**Product Features:**

- Anti-hot function.
- Anti-heavy weight function.
- Anti-collision function when open.
- Anti-collision function when close.

Specifications:

مشخصات:

Voltage (V)	Opening angle	Opening time	Dimension (mm)	Door width	Door weight	Opening Speed (s)	Closing Speed (s)
AC220/110V	60-120	0-10	500*85*110	500-1200	100	3-10	3-10



Product Features:

- Connecting two separate operators , Interlock capability
 - Single leaf , Double leaves
 - cross section very beautiful
 - Brush less Motor
 - Manual key output
 - Receiver six mode : Automatic mode , Lock mode , Always open mode , Winter mode (Half-open mode) , One side opening mode , One time crossing mode
 - Six setting switch of changing direction: Open and close adjustment , Slow opening and closing adjustment , Open and close changing mode , Set the interval between opening and closing
- Capability of installing any kind of accessories such as: Electronic Lock , Any kind of manual key , Any kind of login password panel , Fingerprint panel , Battery

Specifications:

Model	Each leaf weight (kgs)	Each leaf wide (mm)	Voltage (v)	Opening speed (cm/s)	Closing speed (cm/s)	Opening time (s)	Force to open manually (N)	Operating temperature
C029	120	1250	24.5	15-50	10-45	0-20	<50	-20C +70C



● Belt



● Remote

● Hanger

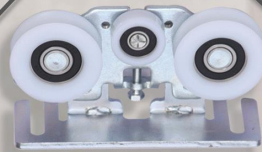

● Stopper



● Receiver



● Photocell



● Polly

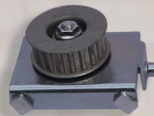

● Motor

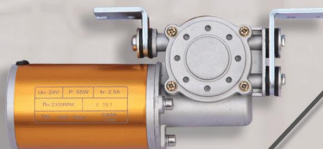

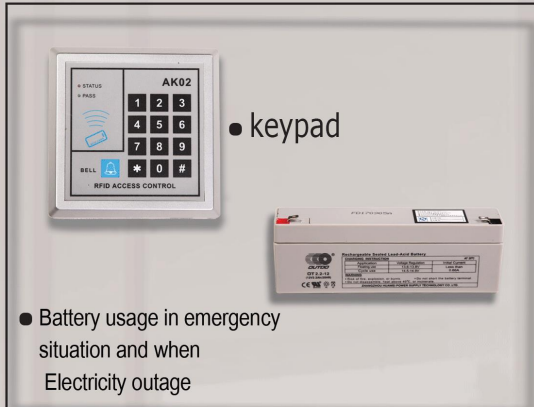

Hulte
Automatic Curtain
Motor



Automatic Curtain
Motor : HC 29



Curtain Motor



Product Features

- Variety in controlling methods
- Automatic Start with hand
- Noiseless , Soft move
- Adjustable speed

Specifications : Single Motor 1N.M

Rail length Fabric weight Rail type	Fabric Weight		
	4m	8m	12m
	60Kg	55Kg	50Kg
	50Kg	45Kg	40Kg
	45Kg	40Kg	35Kg
	40Kg	35Kg	30Kg
	35Kg	30Kg	25Kg
	30Kg	25Kg	20Kg
	31Kg	21Kg	
	21Kg	16Kg	

Double Motor 1N.M

Rail length Fabric weight Rail type	Fabric Weight
	12m
	90Kg
	70Kg
	60Kg
	50Kg
	40Kg
	30Kg
	30Kg
	23Kg

Model	Torque	Speed	Diamension	Rated Power	Voltage	IP Class
HC 29	1N.m	17-20cm/s	227*80*55mm (L) (W) (H)	80W	AC100-240V 50/60Hz	IP20

GarageDoor Opener

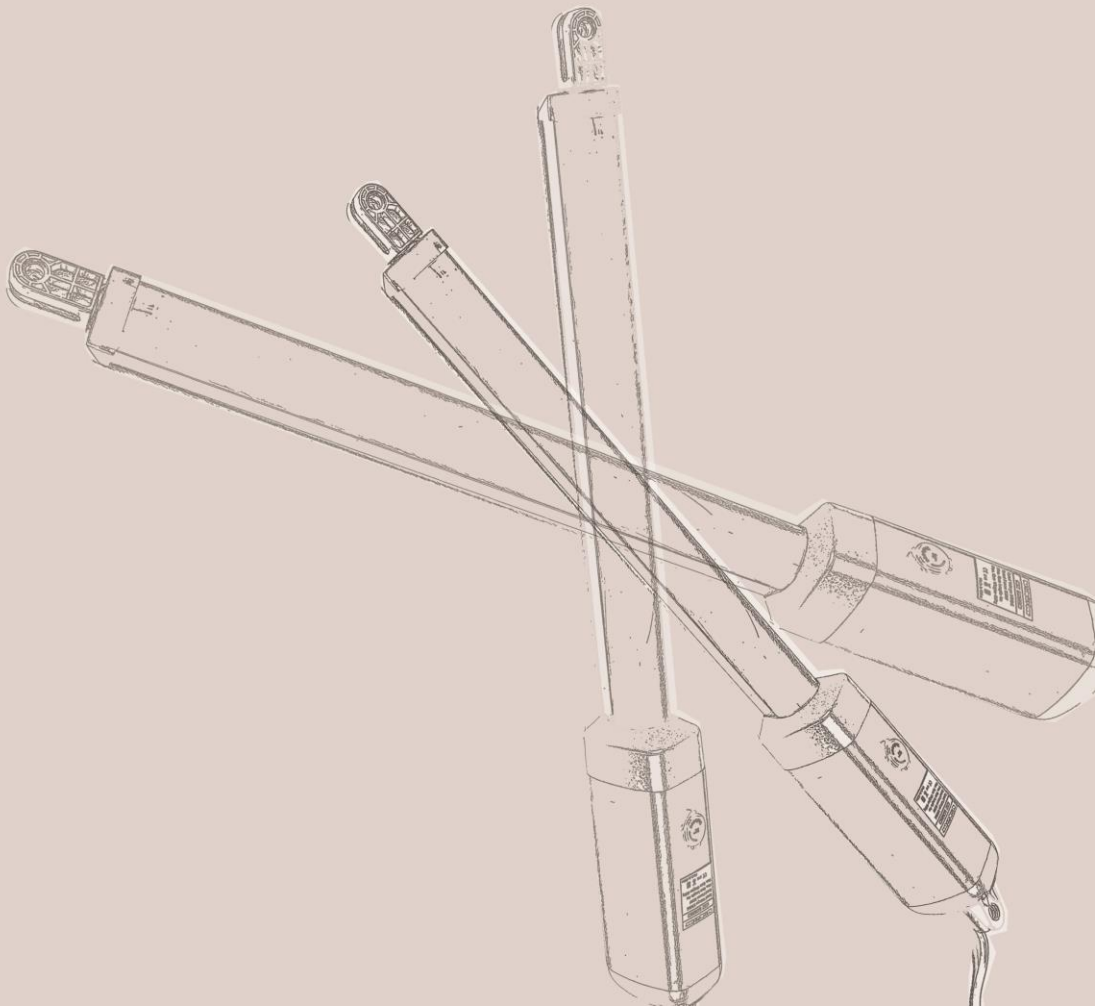

GarageDoor Opener



Product Features:

- Soft start and soft stop.
- Built in max Motor running.
- Dual/Single gate running mode.
- Emergency release key in case of power failure
- Stop/Reverse in case of obstruction during gate.

Specifications:

مشخصات:

Model	Power (W)	Voltage (V)	Speed (r/min)	Max door weight (kgs)	Max door width (m)	IP (IP)
P0301	280	220	1.8	350	4	IP44

The logo for Hulle, featuring the word "Hulle" in a bold, black, sans-serif font. The letter "H" is red, and the rest of the letters are black. A vertical line is positioned to the right of the text.

Hulle

**Garage door opener
pro line A**



Product Features:

- New appearance design
- Service life is longer
- GS,CE approved
- Rohs approved
- Low noise



Product Features:

- Pass door protection interface as optional
- Manual release in case of power failure
- Auto close option can be enabled
- Flash light interface as optional
- Wall switch interface available
- Photocell interface available
- Automatic safety revers
- Overload force detecting
- Low-voltage protection
- Soft start, soft dtop
- Electronic limit



Model	Pro line 600 A	Pro line 800 A	Pro line 1000 A	Pro line 1200 A
Input voltage	220- 240V AC 50/60HZ	220- 240V AC 50/60HZ	220- 240V AC 50/60HZ	220- 240V AC 50/60HZ
Power input	200 W	235 W	245 W	260 W
Max force	600 N	800N	1000N	1200N
Opening speed	0.18M/S	0.18M/S	0.18M/S	0.18M/S
Lamp	LED	LED	LED	LED
Light time	3 minutes	3 minutes	3 minutes	3 minutes
Decoding	Rolling code	Rolling code	Rolling code	Rolling code
Radio frequency	433.92MHZ or other on request	433.92MHZ or other on request	433.92MHZ or other on request	433.92MHZ or other on request
Working temperature	-20~40 °C	-20~40 °C	-20~40 °C	-20~40 °C
Relative humidity	< 90%	< 90%	< 90%	< 90%
Max door area	10 square materes	12 square materes	14 square materes	16 square materes



All information contained is correct at the time of printing,Product specifications can change without notice

Hulle

Garage door opener
HL - SERIES



Product Features:

- Up to 5 years guarantee
- Motion sensor available
- Robust quiet operation
- Very quiet operation
- Easy programming
- Easy for installation



Technical Details

Model	HL 1/2 HPs	HL 3/4 HPs	HL 1-1/4 HPs
Power input	200 W	235 W	245 W
Input voltage	110- 120V AC, 60HZ	110- 120V AC, 60HZ	110- 120V AC, 60HZ
Lamp	LED 24V DC	LED 24V DC	LED 24V DC
Light time	3 minutes	3 minutes	3 minutes
Working temperature	-20~40 °C	-20~40 °C	-20~40 °C
Relative humidity	< 90%	< 90%	< 90%
Max. force	600 N	600 N	600 N
Decoding	Rolling code	Rolling code	Rolling code

Technical Details

Soft start, soft stop	Motion sensor available
Fast automatic safety reverse	O/S/C button available
Safety sensor	Extended WIFI interface available
Highlight courtesy LED	Faster running speed
Electronic limit	Easy programming
Overload force detecting	manual release in case of power failure



Applications:



Section door

Up-and-over door

Swing gate

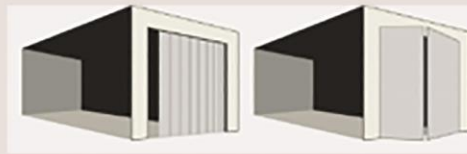

Sliding gate

Double gate

More details:



Motion sensor



Easy programming



Highlight LED

**All information contained herein is correct at the time of printing.
Product specifications can change without notice.**

- Sectional rails as first pictures is ofen used DIY market.
- Ps : DIY market mean Do it Yourself market that end users may installed GDO by themselves.
- One- piece rails are mainly used in professional market.

Compared with sectional rails, one - piece rail is

1. with lower cost,
2. more easier to install,
3. end if rail length is over 3.5m, one - piece rail is more secure as sectional rails are connected by joiners.





Huller

Detaild information for
UL certified GDO

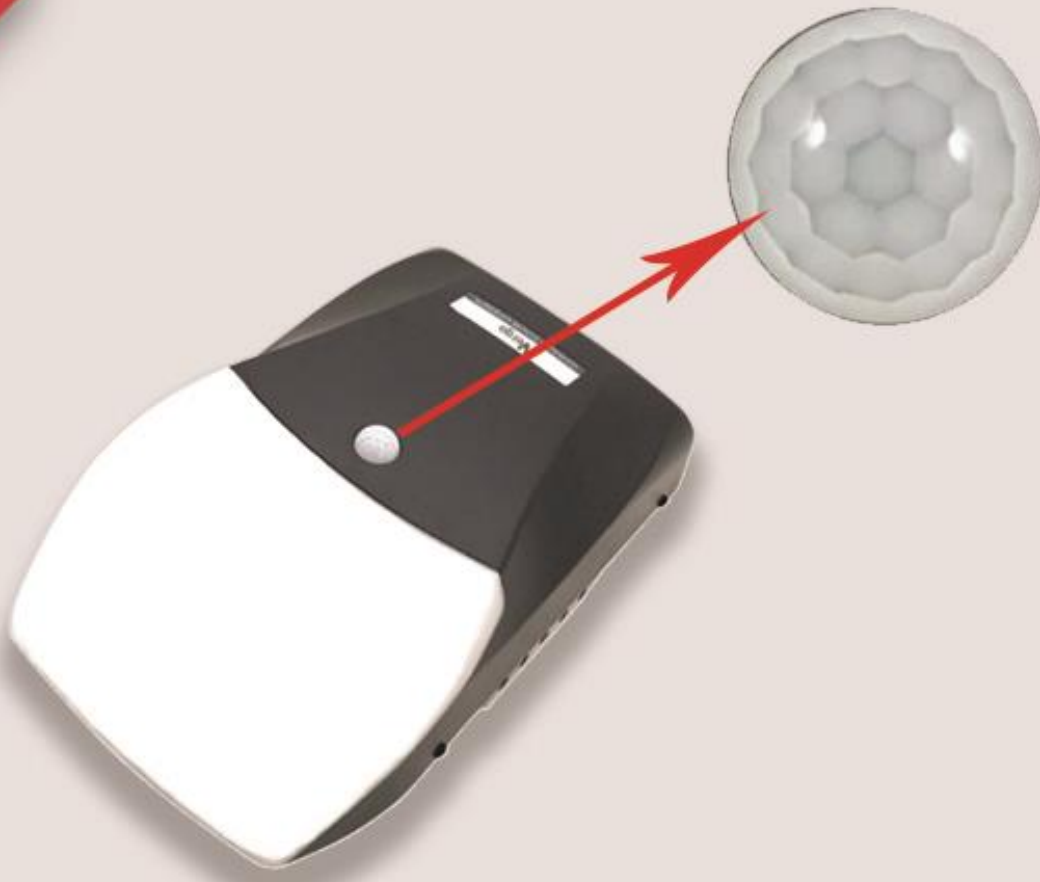

Motion detector is a device that detected moving objects, particularly people. Such a device is integrated as a component of a garage door opener that automatically lets LED lights on to alert the user of motion in an area.



Detailed information for
UL certified GDO

Outdoor opener keypad is installed outside the door to open the door with password. It has four channels.



Indoor keypad is installed inside the door to open the door. It has two channels.



Add:No.389, Alley 9/2,Alley 12,West Ghoddusi Blvd, Shiraz,Iran
Postal Code:71868-76458



www.hutteco.com